

# Radius<sup>HD</sup> stands

Assembly Instructions

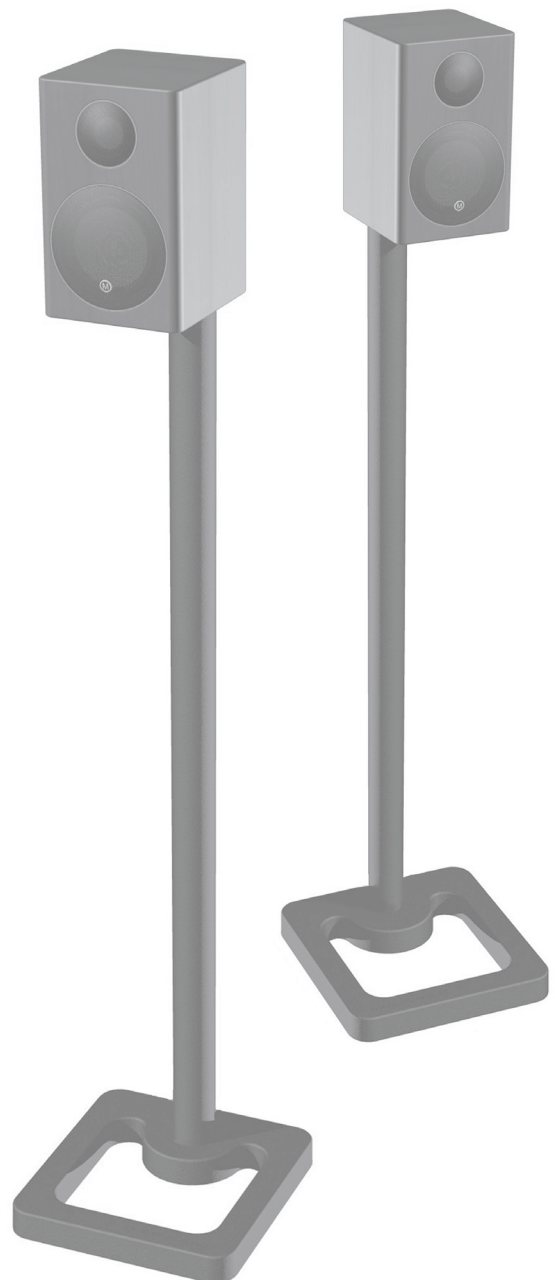

## Hard Floor

The stand base will come ready for use on hard floors, with the rubber feet pre-assembled into base.

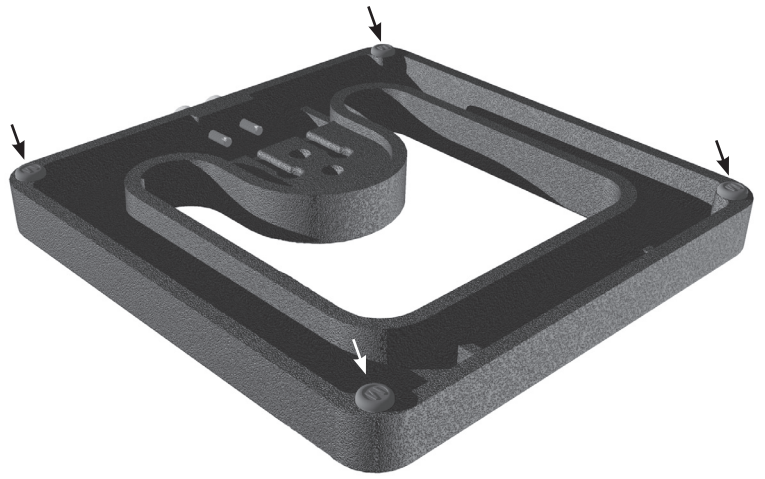

## Carpeted Floor

When using on carpeted floor, you will gain better stability and improved sound quality by using the spikes. To use these, simply remove the rubber feet and replace them with the spikes. To remove the rubber feet simultaneously twist and pull them. Then screw the spikes in their place.

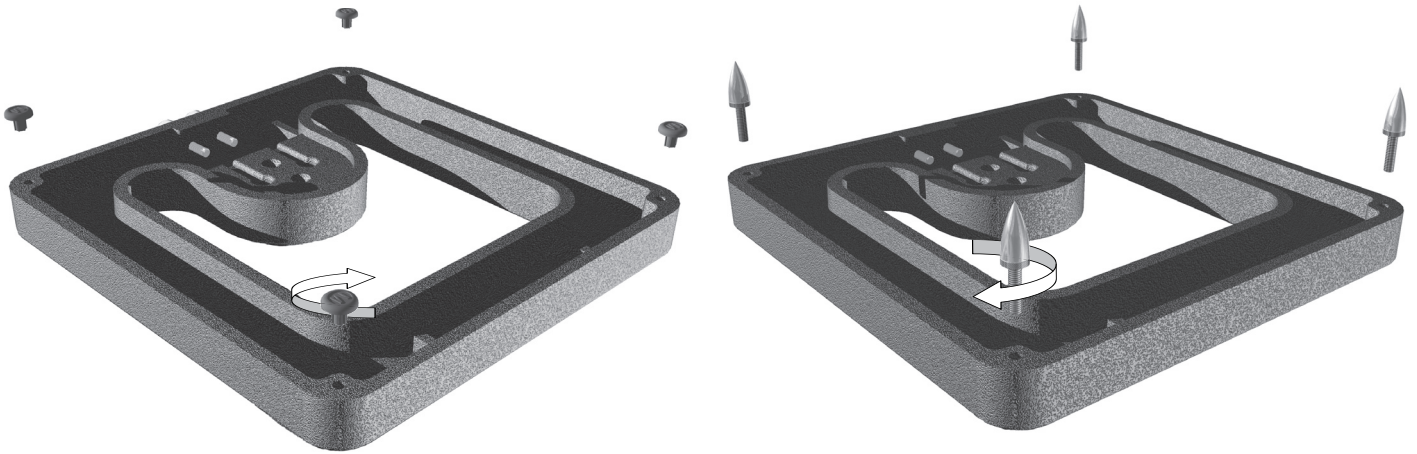

## Assembly

Place the pole into the aperture in the base and line up the screw holes, ensuring the terminals in the housing at the top are facing forward.. The screw holes are the ones that run from front to back. The cables also needs to be fed through the holes. They run from left to right.

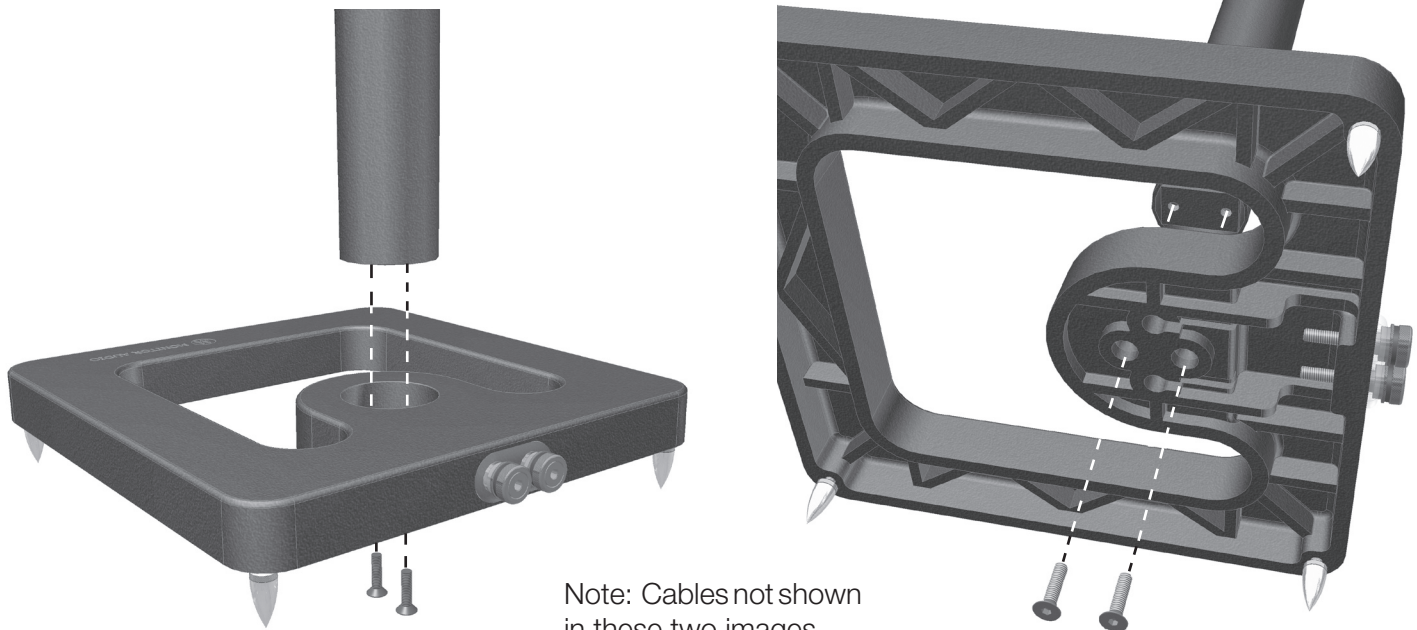

Note: Cables not shown in these two images

## Connecting The Cables

When the screws have been securely tightened, the cables should be connected to the spade terminals. The female terminals on the cables simply push onto the male terminals on the stand. The positive is marked with a red band.

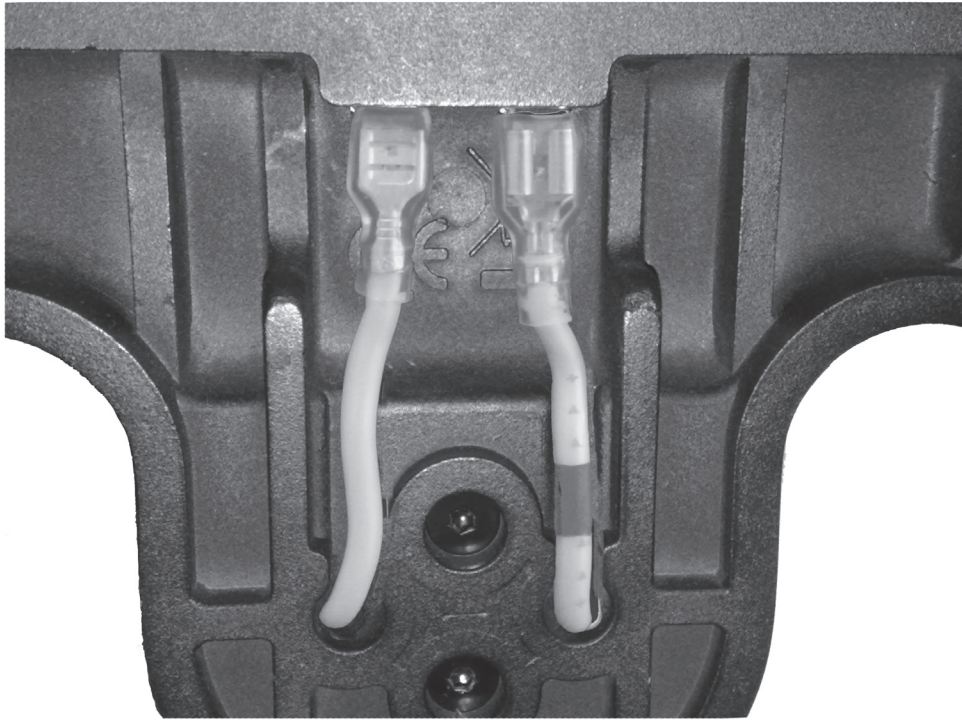

## Connecting The R45<sup>HD</sup> / R90<sup>HD</sup>

Turn the stand over so that it is now the correct orientation. Remove the two button head screws (either side of the terminals) from the back of the R45<sup>HD</sup> / R90<sup>HD</sup>.

Line the R45<sup>HD</sup> / R90<sup>HD</sup> up to the terminals, and press into place. Fix in place using the two screws you have just removed.





Monitor Audio Ltd.  
Unit 2, 24 Brook Road  
Rayleigh, Essex  
SS6 7XL  
England  
Tel: 01268 740580  
Fax: 01268 740589  
Email: [info@monitoraudio.co.uk](mailto:info@monitoraudio.co.uk)

[monitoraudio.co.uk](http://monitoraudio.co.uk)  
Designed in the United Kingdom

© 2008. Version 2